

SISYPHUS

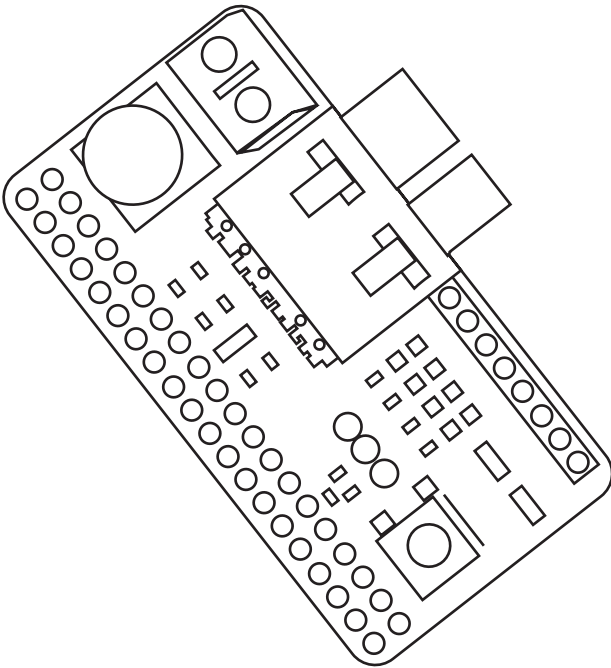

RGBW CONVERTER KIT
USER MANUAL



CONTENTS	1
SETUP	2
ATTACHING CONVERTER KIT	4
REMOVING OLD LEDS	6
SETTING UP LEDS	7
RESET YOUR TABLE	11

For the latest version of this manual, additional tutorials, and troubleshooting, please go to:

sisyphus-industries.com/support

CONTENTS

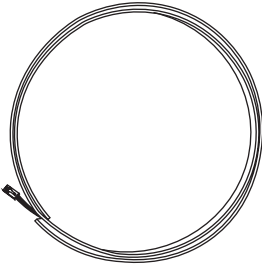

RGBW STRIP

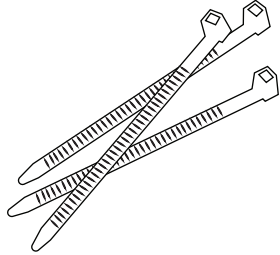

ZIP TIES

**Coffee Tables Only*

**Two Prong for
Coffee Tables Only*

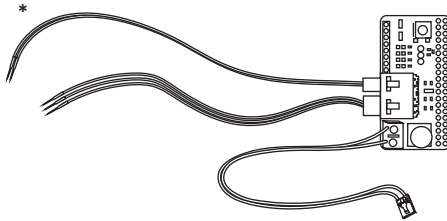

CONVERTER
ASSEMBLY

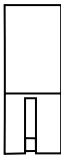

3-WIRE PLUG CAP

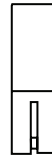

2-WIRE PLUG CAP

SETUP

- 1.** Unplug your Sisyphus Table from your wall outlet.
- 2.** Remove the glass top and ring from your table. Carefully set aside.
- 3.** At the edge of your table, locate the red and black wire connected to the end of the existing lights. Cut the wire near the hole in the table top where the cord comes from.

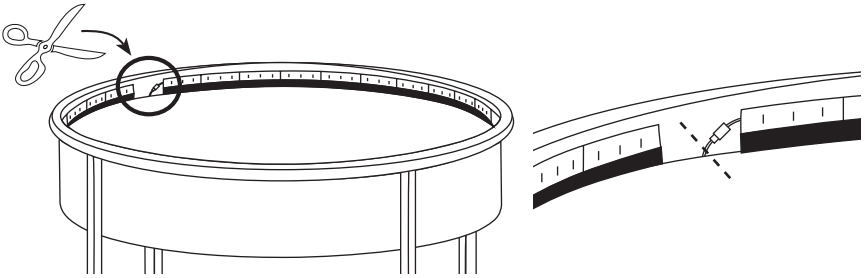

- 4.** Peel out the old light strip by firmly pulling at the strip from one end.
 - a.** There is a strong double-sided tape holding the lights into place at several points around the table. Firmly but carefully pull on the light strip to peel off the adhesive.
 - b.** Remove any excess tape from the inner edge of the table.

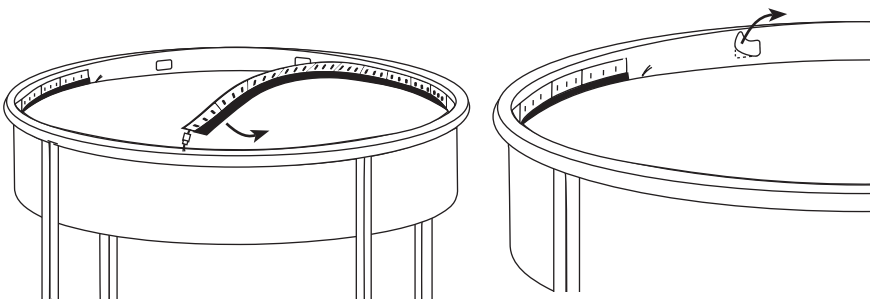

*The next steps require accessing several components on the underside of your table which can be difficult to reach. **If you are able to access the underside easily without flipping the table over, proceed to step 8.***

- 5.** Remove the sand from your table; Using a piece of thick paper or cardstock, push the sand into a single pile in the center of your table and carefully scoop as much sand as you can into a plastic bag or container.
- 6.** Once you have scooped out all of the sand you can, some will still remain in the fabric fibers of your table. It is necessary to use a small vacuum to fully remove the sand from the fabric. This will prevent excess sand from damaging the electronics or scratching the glass and furniture.
- 7.** Flip your table upside down on a clean, flat surface. (Place a protective sheet such as newspaper down first to protect the surface from sand).
- 8.** From the underside of your table, disconnect the red/black wire and black power cable running to the sisbot. To remove the red/black wire, depress the small tab and pull.

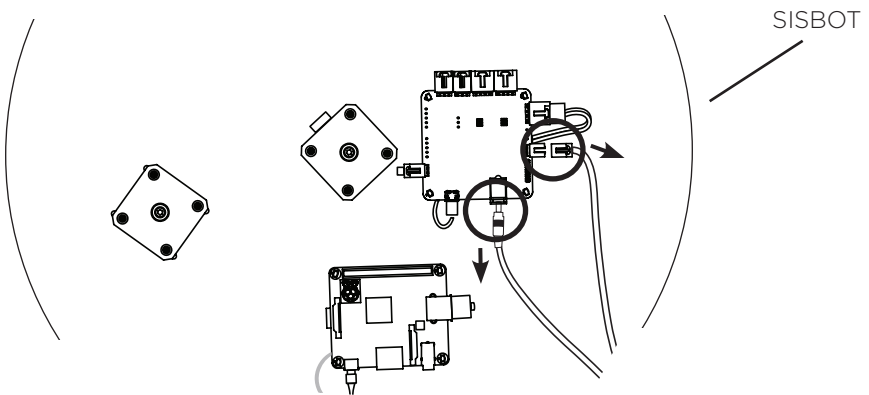

ATTACHING CONVERTER KIT

9. Flip over your sisbot.

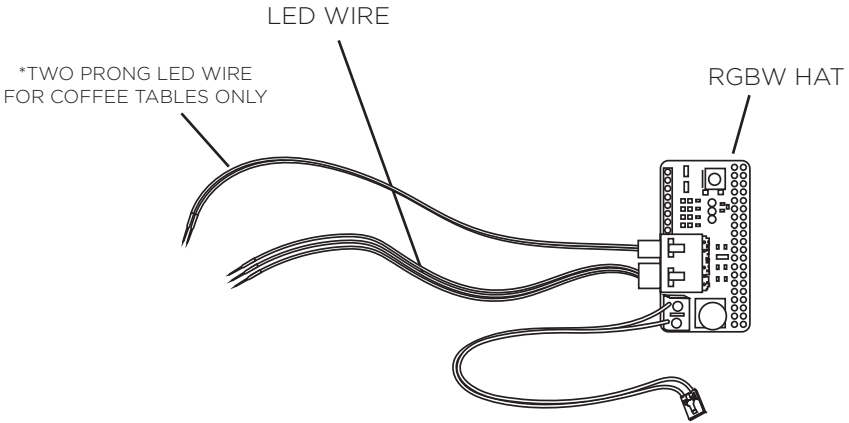

10. Locate the green Raspberry Pi on the underside of the sisbot. *If you have not removed the sand, you can leave your table upright and access the necessary components from the underside*

a. Plug the RGBW hat into the Raspberry Pi as shown below.

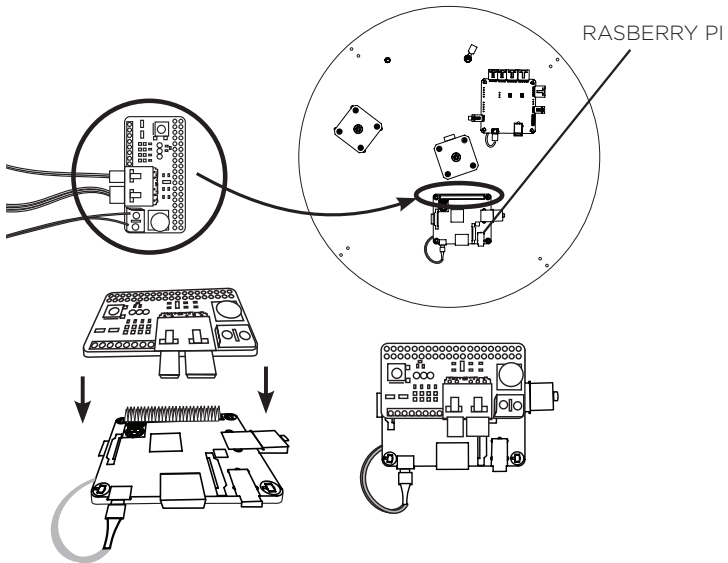

11. Plug the remaining cable from the DC/DC converter into the black board, routing the wire exactly as shown below.

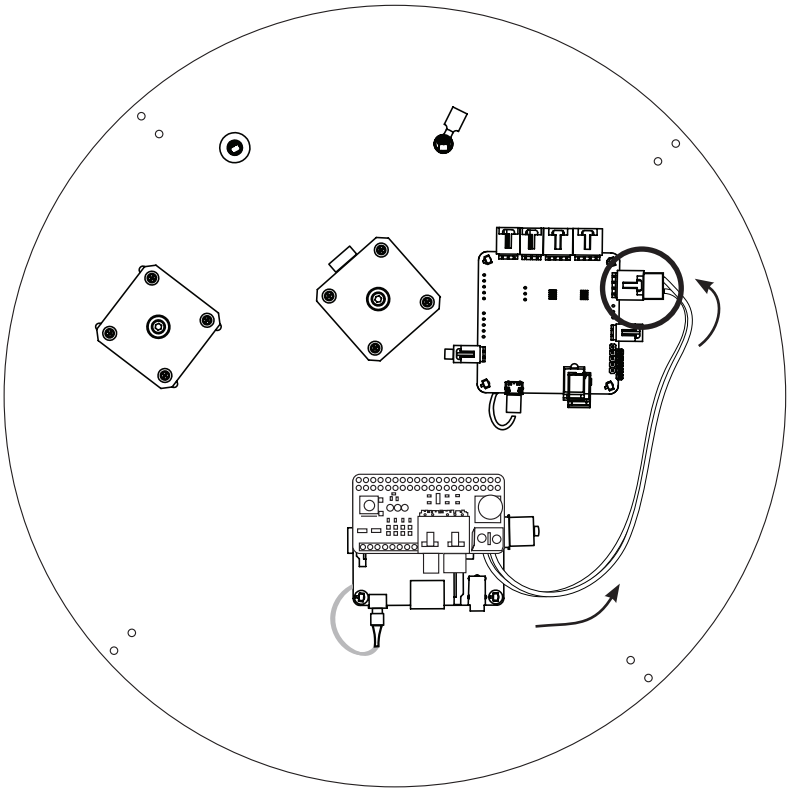

REMOVING OLD LIGHT CABLES

- 12.** From the underside of your table, locate the slit used to run wires through to the top of the table.
- a.** Remove any excess silicone to clear the hole for the new cable(s). Use a dull, flat object such as a butter knife or screwdriver if necessary.

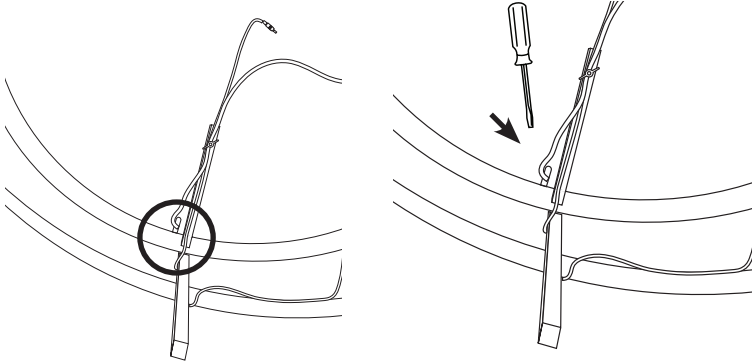

- 13.** Gently pull the existing wire out through this slit (This is the LED cable you cut in step 3), leaving the black power cable attached to the table frame.

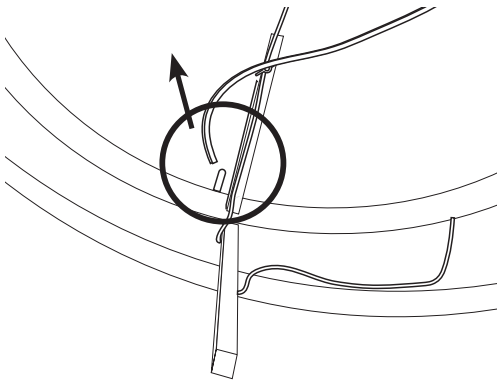

SETTING UP LEDS

- 14.** Grab the remaining LED wires coming out of the RGBW Hat.
 - a.** Side tables have just one wire set, coffee tables have 2 sets of wires. (*Depicted is a Coffee Table*).

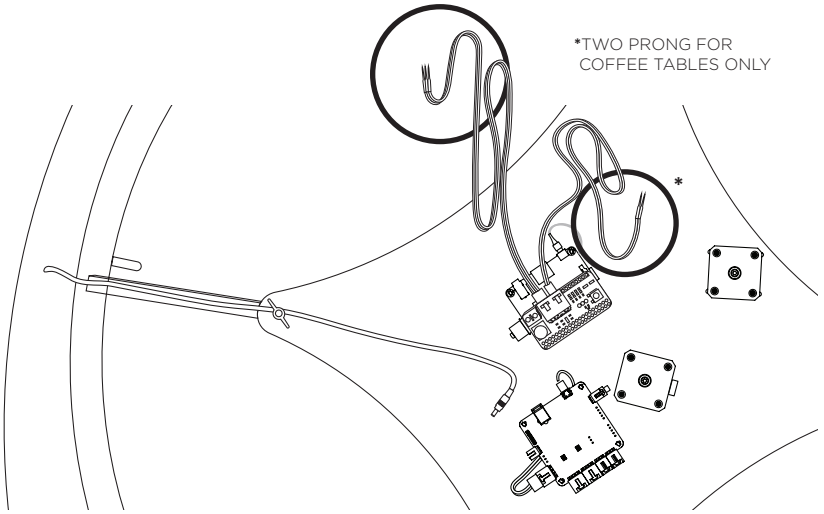

- 15.** Carefully push the LED wires through the opening in the pan and pull through from the other side.

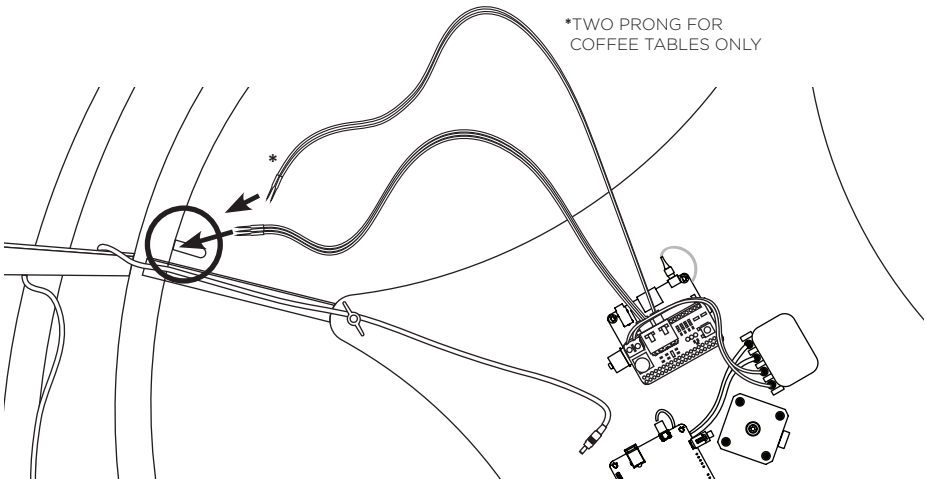

16. Use the provided zip ties to secure the new wires to the frame of the table.

- a.** Leave a little bit of slack where the wires plug into the RGBW hat, and pull any excess wire through to the top of your table so the underside looks like the picture below.

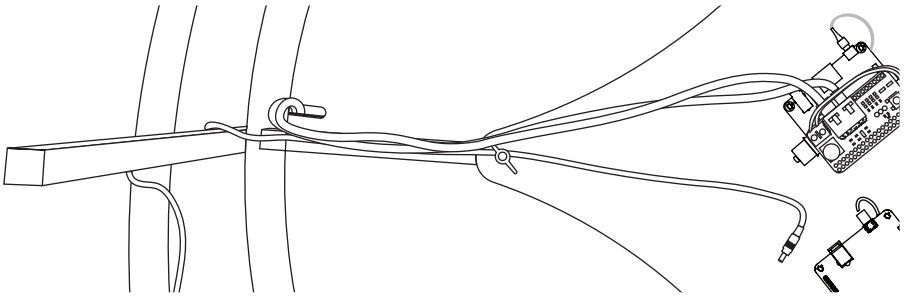

- b.** Use two zip-ties to attach the new wires to the same bar the power-cord is attached to and pull tight. One zip-tie should be close to the sisbot, while the other should be as close to the outer edge of the table as possible.

- c.** Cut the tabs off the zip ties with scissors.

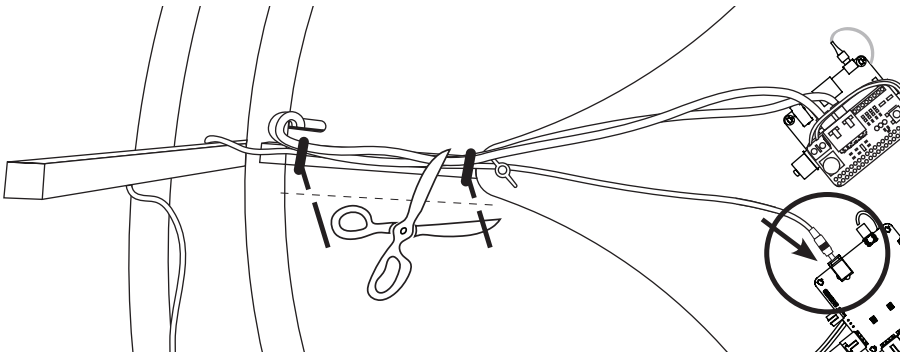

17. Plug the black power cable back into the sisbot as shown above.

18. Flip your table upright.

19. From the top of your table, insert the metal ends of the wires into the 3-wire plug cap.

a. To prevent damage to the lights, double check the wires are inserted **exactly** as shown below. Match the wire color with the markings on the cap.

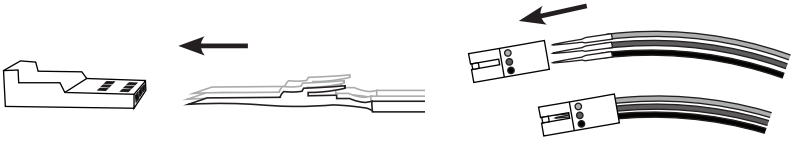

20. For coffee tables, repeat for the 2-wire plug cap.

a. To prevent damage to the lights, double check the wires are inserted **exactly** as shown below. Match the wire color with the markings on the cap.

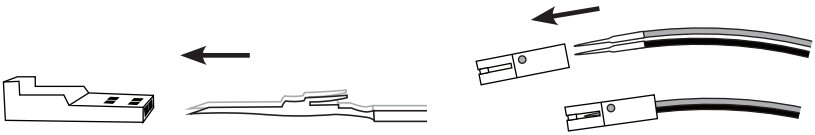

21. Plug the 3-wire plug into the RGBW strip. For coffee tables, also plug in the two wire plug to the opposite end.

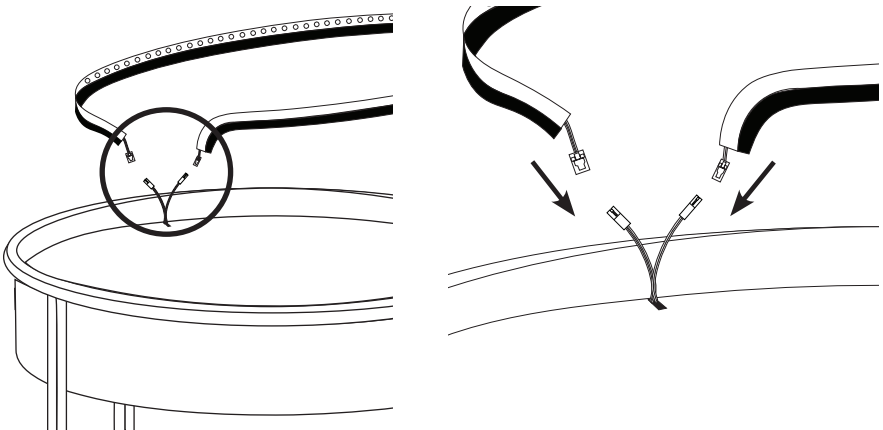

22. Working counter-clockwise, peel off the backing on the first adhesive square. With most of the slack pulled out of the wire, firmly press the strip against the outer edge of the table to adhere it in place.

- a.** For Coffee Tables, the red/black wire should run out of slack first, tuck the rest of the wires behind the LED strip while applying the adhesive.

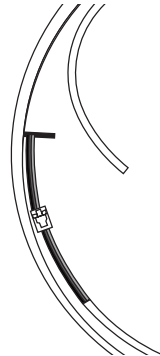
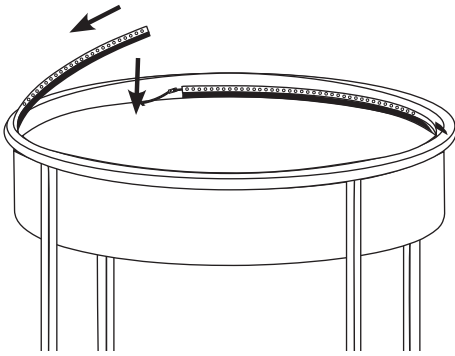

SIDE TABLE

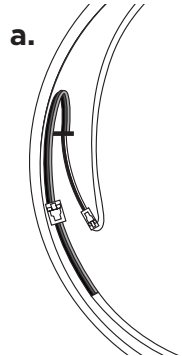

COFFEE TABLE

23. Continuing counter-clockwise, peel the film off the remaining adhesive squares one at a time until all parts of the RGBW strip are adhered to your table.

- a.** The final piece of tape will overlap the beginning of the LED strip. Press firmly to keep in place.

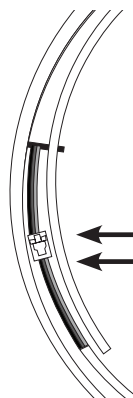
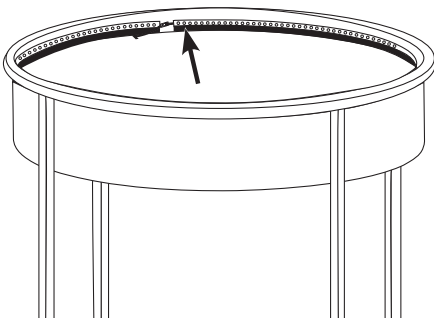

SIDE TABLE

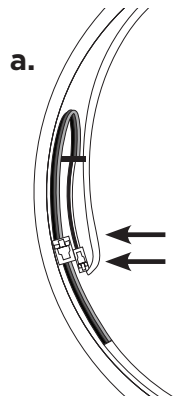

COFFEE TABLE

RESET YOUR TABLE

- 24.** Place the original ball in the center of your table.
- 25.** Plug in your table and wait about 1 min. **Your lights will not start working yet.**
- 26.** Connect to your table with the Sisyphus app or computer browser.
- 27.** Ensure your table is up to date
 - a.** From the Settings menu in the Sisyphus app, select “Firmware Update”.
- 28.** Navigate to the settings menu in the bottom, right corner:
 - a.** Tap the “Settings” title bar at the top of the screen 7 times.
 - b.** Scroll down and tap “Advanced” and then “Table Settings”.
 - c.** Tap the “Configuration File” box.
 - i.** For Side Tables, select “Side Table (2024)”
 - ii.** For Coffee Tables, select “36 Coffee Table (2024)”
 - d.** Scroll to the bottom and press “Save”.
- 29.** Wait for your table to reset, then replace the sand, ring, and glass back onto your table.
- 30.** Enjoy! For instructions on how to use your new lights, visit sisyphus-industries.com/support for the latest table manuals.

For instructions on how to use your new
lights, visit

sisyphus-industries.com/support

for the latest table manuals.

